

Replacement Models

H.P.	Volts	Amps	RPM	Spd.	Model	Fig.	Type	Mtg.	Dia.	Rot.	"A" Dim	Shaft Dia. and Length	Reference No.
TRANE													
69CFM	208-240	.5	3000	-	A069	A	SP	Stud	3.3	C.C.W.	-	-	38040252, 82252
75CFM	230	.4	3000	1	A075*	B	SP	Stud	3.3	C.C.W.	-	-	38050005
1/8	230	1.1	1550	1	D1050†	C	PSC	Band	5.0	C.W.	3-1/4	1/2 x 3	WW94X236SP WW94X936PSC
1/8	208-230	.8	1650	1	D895#	D	PSC	Stud	5.6	C.W.	3-1/4	1/2 x 1-1/2	5KCP39BGR4265 MOT 6363
1/10	460	.5	1075	2	D1005	N	PSC	Base	5.12	D.S.	3-1/4	9-5/8 x 1/2 x 9-5/8	5KCP29DK3857BT MOT 4590
1/15	115	1.3	850	3	D1089#	E	PSC	Base	5.0	Rev.	3-1/4	1/2 x 3	5KCP39DGM458AS, K48HXCFC-1327 MOT3589, MOT 3591 FASCO 7176-3020
1/15	115	.8	1100	3	D1090	F	PSC	Base	5.1	C.W.	3-1/2	10-1/2 x 1/2 x 11-1/2	MOT1877, K48HXBJA-956
1/25-1/40	115	.6-.4	1060-500	2	D1051+	G	PSC	Base	5.0	D.S.	3-1/4	11-1/8 x 1/2 x 11-1/8	Fan Coil
1/20-1/30-1/40	265	.5-.3	1100	3	D1058#	H	PSC	Lug	5.0	C.W.	3-5/8	1/2 x 2-1/2	5KCP29FK8855
-	115	0.95	3000	1	A143	I	SP	-	3.3	C.W.	-	-	TRANE, 7021-8428, 7021-8013, 7021-8924
-	115	1-.35	3000	2	A146	J	SP	-	3.3	C.W.	-	-	TRANE, 7021-7986, 7021-8925, 7002-2531
-	115	.7	3450	1	A130	K	PSC	-	3.3	C.W.	-	-	TRANE, 7062-3956, 7062-3616
-	208-230	.5	3000	1	A150	L	SP	-	3.3	C.C.W.	-	-	TRANE, 7021-7833, 7021-8928
20th CENTURY													
-	115	1.3	3200	1	A086	M	SP	-	-	C.W.	-	-	7021-5853

NEW

• Ball bearing motor + 6M 370 V capacitor # 4M 370V capacitor
 † Original motor is shaded pole, D1050 is PSC to provide greater motor efficiency and permit closing shaft end of motor to prevent moisture from entering motor

NOTE: Rotation is determined by looking at shaft end. Shaft length is measured from motor face.



Fig. A A069



Fig. D D895



Fig. G D1051



Fig. J A146



Fig. M A086



Fig. B A075



Fig. E D1089



Fig. H D1058



Fig. K A130



Fig. N D1005



Fig. C D1050



Fig. F D1090



Fig. I A143



Fig. L A150

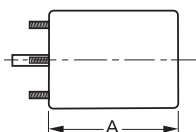

Products on this page are NOT SUITABLE for unattended equipment unless indicated by ► symbol. See inside back cover for additional information.

PSC motors use 5M 370V capacitors unless otherwise indicated.